

**SKANSKA**Working on  
behalf of**HS2**

## Notification



# Regent's Park Estate night time works

September 2019 | [www.hs2.org.uk](http://www.hs2.org.uk)

High Speed Two (HS2) is the new high speed railway for Britain.

## Night time scaffolding and equipment delivery

During October we will be working during Network Rail engineering hours to install scaffolding on Stalbridge House, within the Regent's Park Estate construction site. Due to the proximity of the building to the railway we need to carry out this work when there are no trains running on the lines below. All delivery vehicles will access the site via Granby Terrace Bridge.

We will be working overnight on the following weekends:

**12 to 13 October between 10.30pm and 8am**

**19 to 20 October between 10.30pm and 8am**

**26 to 27 October between 10.30pm and 8am**

Please see the map below which shows the location of these works.

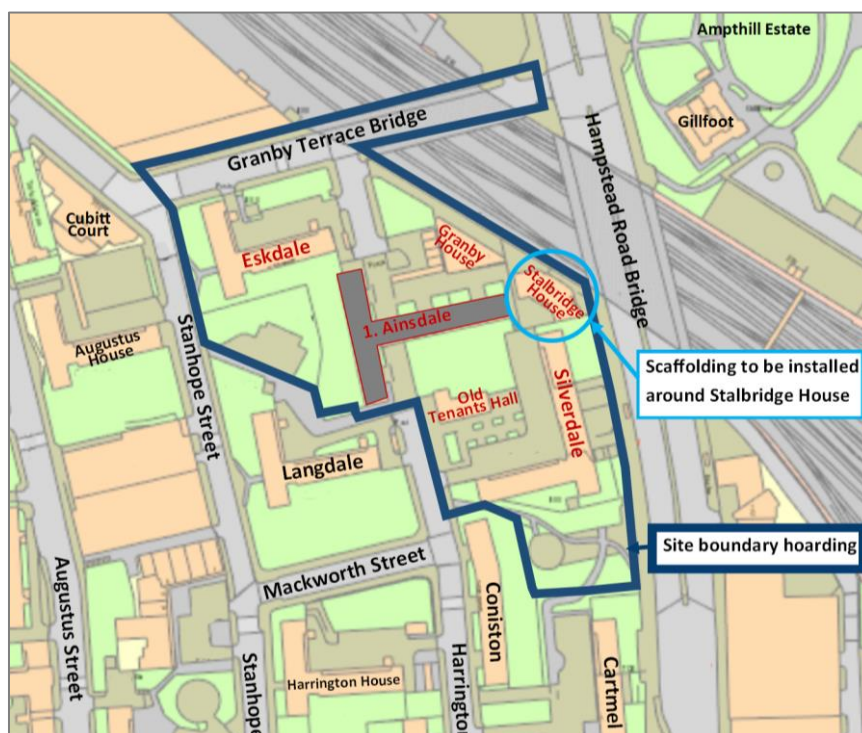

## Duration of works

Overnight Saturday to Sunday

12 to 13 October

19 to 20 October

26 to 27 October

## Working hours:

10.30pm to 8am

## What to expect

Night time working

Delivery vehicles via Granby Terrace Bridge

Staff on site carrying out scaffolding erection

## What we will do

Keep noise to a minimum at all times

Inform you of any changes to these dates; sign up to receive news alerts at

[HS2inCamden.co.uk](http://HS2inCamden.co.uk)

Contact our HS2 Helpdesk team on **08081 434 434**

# Regent's Park Estate night time works

[www.hs2.org.uk](http://www.hs2.org.uk)

## Equipment delivery for ground investigations

Overnight on the 19 and 26 October, between 10.30pm and 8am we will also deliver machinery and equipment to the trackside near Granby Terrace Bridge. A crane will be installed to lift equipment onto the trackside, as shown in the map below.

This is to support ground investigation works that will take place during normal day time working hours between 21 October and 1 November for approximately one week.

Please see the map below which indicates the location of these works.

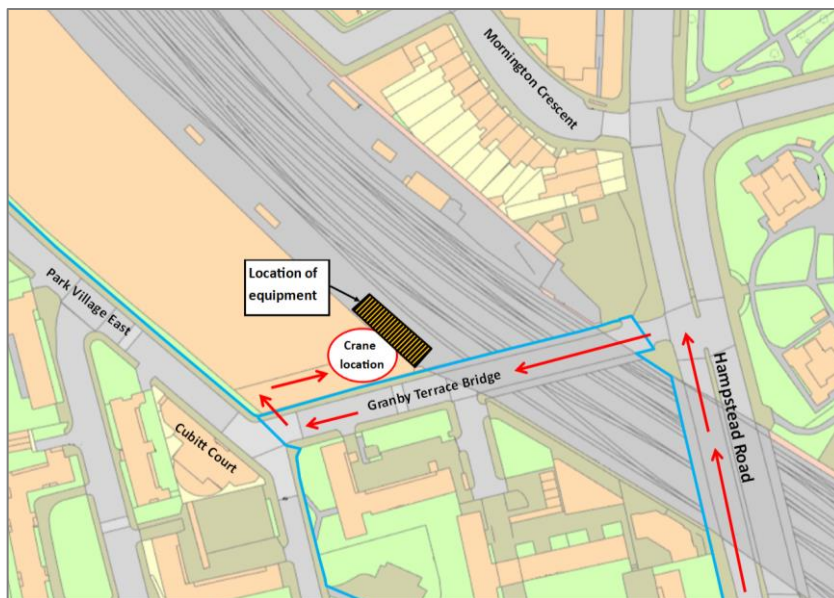

**If you have a question about HS2 or our works, please contact our HS2 Helpdesk team on 08081 434 434 or email [HS2enquiries@hs2.org.uk](mailto:HS2enquiries@hs2.org.uk)**

## Notification



### Duration of works

Deliveries overnight  
Saturday to Sunday

**19 and 26 October**  
from **10.30pm to 8am**

Ground investigation  
works at track level  
from **21 October** for  
approximately one  
week between 8am  
and 6pm

### What to expect

Night time deliveries

Delivery vehicles via  
Granby Terrace  
Bridge

Crane movements to  
deliver machinery  
and equipment

### What we will do

Keep noise to a  
minimum at all times

Inform you of any  
changes to these  
dates; sign up to  
receive news alerts at  
**[HS2inCamden.co.uk](http://HS2inCamden.co.uk)**

# Keeping you informed

We are committed to keeping you informed about work on HS2. This includes ensuring you know what to expect and when to expect it, as well as how we can help.

## Residents' Charter and Commissioner

The Residents' Charter is our promise to communicate as clearly as we possibly can with people who live along or near the HS2 route.

[www.gov.uk/government/publications/hs2-residents-charter](http://www.gov.uk/government/publications/hs2-residents-charter)

We also have an independent Residents' Commissioner whose job is to make sure we keep to the promises we make in the Charter and to keep it under constant review. Find reports at:

[www.gov.uk/government/collections/hs2-ltd-residents-commissioner](http://www.gov.uk/government/collections/hs2-ltd-residents-commissioner)

You can contact the Commissioner at:  
[residentscommissioner@hs2.org.uk](mailto:residentscommissioner@hs2.org.uk)

## Construction Commissioner

The Construction Commissioner's role is to mediate and monitor the way in which HS2 Ltd manages and responds to construction complaints. You can contact the Construction Commissioner by emailing:  
[complaints@hs2-cc.org.uk](mailto:complaints@hs2-cc.org.uk)

## Property and compensation

You can find out all about HS2 and properties along the line of route by visiting:

[www.gov.uk/government/collections/hs2-property](http://www.gov.uk/government/collections/hs2-property)

Find out if you're eligible for compensation at:

[www.gov.uk/claim-compensation-if-affected-by-hs2](http://www.gov.uk/claim-compensation-if-affected-by-hs2)

## Holding us to account

If you are unhappy for any reason you can make a complaint by contacting our HS2 Helpdesk team. For more details on our complaints process, please visit our website:  
[www.hs2.org.uk/how-to-complain](http://www.hs2.org.uk/how-to-complain)

## Somali

Fadlan nala soo xirii haddii bug-yarahaan bilaashka ah ku rabsid daabacad far waa-wayn, qoraalka indhoolaha, hab maqal ah ama si fudud loo akhrin karo. Waxaan xittaa macluumaadka ku bixin karnaa luqado kala duwan. Qof ayaad ka codsan kartaa inuu wakiil ka noqdo markaad la hadlayso HS2 Ltd.

## Español

Póngase en contacto con nosotros en caso de que desee recibir una copia gratuita de este folleto en caracteres grandes, braille, audio o en formato de lectura fácil. También podemos proporcionar la información en distintos idiomas. No dude en pedirle a alguien que le represente en cualquier conversación con HS2, Ltd.

## Français

Merci de nous contacter si vous désirez une copie de cette brochure en grands caractères, en braille, en version audio, ou en lecture simplifiée. Nous pouvons également vous fournir des informations dans différentes langues. Vous pouvez demander d'être représenté(e) par un tiers pour tout échange avec HS2 Ltd.

## Bengali

যদি আপনাকে এই প্রচারপত্রটি বড় অক্ষর, ব্রাইল, অডিও বা সহজ পাঠ্যযোগ্য বস্তুমূলের প্রতিলিপিতে প্রাপ্য করে অগ্রহণ করার আমারই সার্বজনীন প্রত্যাশা। এছাড়াও আমরা বস্তুনিষ্ঠভাবে যথেষ্ট প্রতিক্রিয়া প্রদান করব। এইচএস২ লিমিটেড (HS2 Ltd.)-এর সার্বজনীন প্রত্যাশা।  
আপনাকে প্রতিক্রিয়া প্রদান করার জন্য আপনাকে কৃতজ্ঞতা প্রকাশ করে আপনাকে ধন্যবাদ জানাই।

## Contact Us

Contact our HS2 Helpdesk team all day, every day of the year on:

 Freephone **08081 434 434**

 Minicom **08081 456 472**

 Email **HS2enquiries@hs2.org.uk**

Write to:

**FREEPOST**

**HS2 Community Engagement**

Visit us at the former National Temperance Hospital at **112 Hampstead Road, London NW1 2PS.**

Websites: **[www.hs2.org.uk](http://www.hs2.org.uk)**

**[www.hs2inCamden.co.uk](http://www.hs2inCamden.co.uk)**

**Please contact us if you'd like a free copy of this document in large print, Braille, audio or easy read. You can also contact us for help and information in a different language.**

HS2 Ltd is committed to protecting personal information. If you wish to know more about how we use your personal information please see our Privacy Notice <https://www.gov.uk/government/publications/high-speed-two-ltd-privacy-notice>

High Speed Two (HS2) Limited, registered in England and Wales. Registered office: Two Snowhill, Snow Hill Queensway, Birmingham B4 6GA. Company registration number: 06791686. VAT registration number: 181 4312 30.